



# COLOSSUS<sup>TM</sup>

*Excellence inside*

**DATASHEET**

---

**LS30ISI122500F**



Version: 01

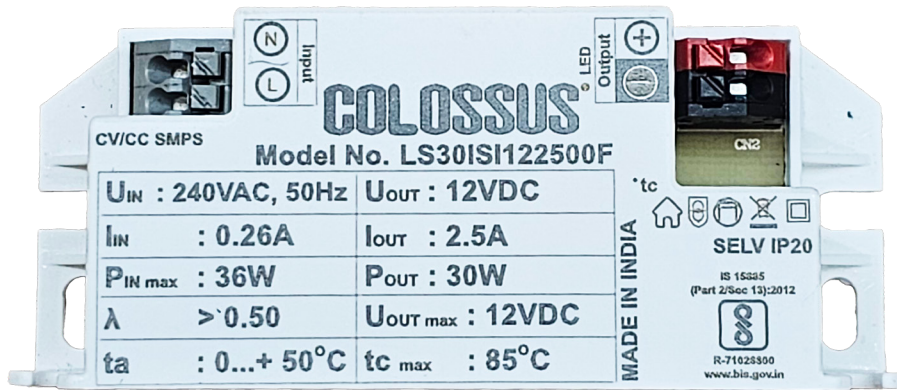

<https://colossusworld.com/>

*\*Image is for viewing purpose. Technical Data not to be drawn from above image.*

### Approval Markings:



### Product Description

- CV/CC Driver for led modules
- Input Voltage 240VAC
- High efficiency >84%(@100% Load)
- Power factor >0.50 (@100%Load)
- For use in combination with luminaries of protection class II.
- Protection against Abnormal Operating Conditions Like Open Voltage Protection, Overload Protection & Short Circuit Protection.
- Surge protection 2.5KV
- Nominal Life Time: 30,000 hours @  $t_c \leq t_{c\max}$

### Functions

- Application oriented operation for maximum compatibility

### Applications

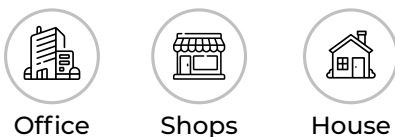

Office

Shops

House

### Technical Data

#### Mains Voltage Supply

Rated Voltage Range	240VAC
Rated Frequency	50/60 Hz
Max. Admissible Input Voltage Range(AC)	175-265VAC
Mains Voltage Withstanding Capacity	320VAC for 2hrs

#### Output Data

##### Constant current

Output Current Tolerance	±5%
Max Starting Time	<1s

#### Interface And Dimming Operation

Dimming Interface	None
-------------------	------

#### Power Factor

240V(@ Full Load)	>0.50
-------------------	-------

#### Efficiency(typ.)

Full Load	>84%
-----------	------

#### Protections

Open Circuit	<13VDC
Output Short Circuit Operation	Yes
Input Over Voltage Cutoff	None
Input Under Voltage Cutoff	None

#### Connection Terminals

	For solid Or stranded wire
Type	Push Terminal
Wire Cross Section	0.5mm <sup>2</sup> - 1.5mm <sup>2</sup>
Wire Stripping Length	8.5mm - 9.5mm

#### Wire Lengths

Max. Wire Length To Led Module	<1m
--------------------------------	-----

### Protection

Surge	2.5kV
High Voltage	320V

### Temperatures (Operation)

Model No.	Ambient(ta)	Case (tc)
LS30ISI122500F	0°C... +50°C	Max + 85°C

### Product Specifications

Model No.	Input Current (max)	Input Power (max)	THD	Power Factor	Efficiency	Output Current	Output Voltage	Output Power (max)
LS30ISI122500F	260mA	36W	N.A	>0.50	>84%	2500mA	12V	30W

All specifications with 240 VAC are nominal operation and 100% load.

### Graphs

Operating Window (CV)

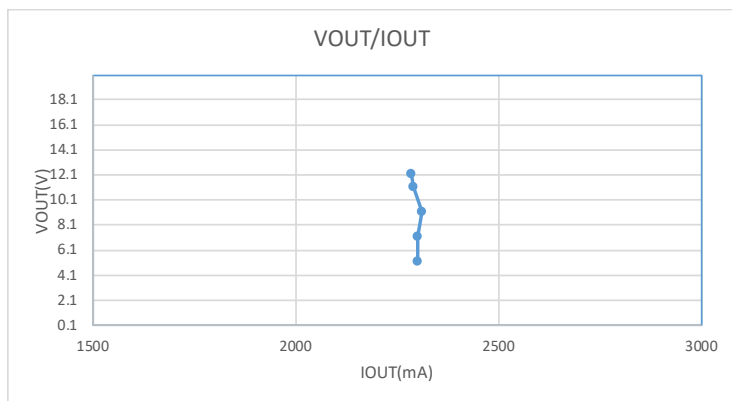

Efficiency Vs Output Power

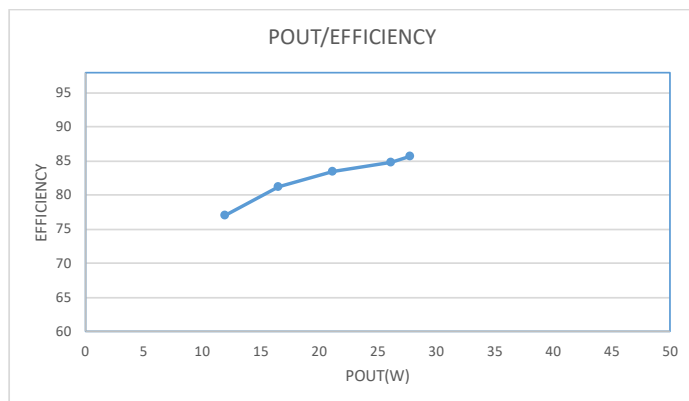

Operating Window (CC)

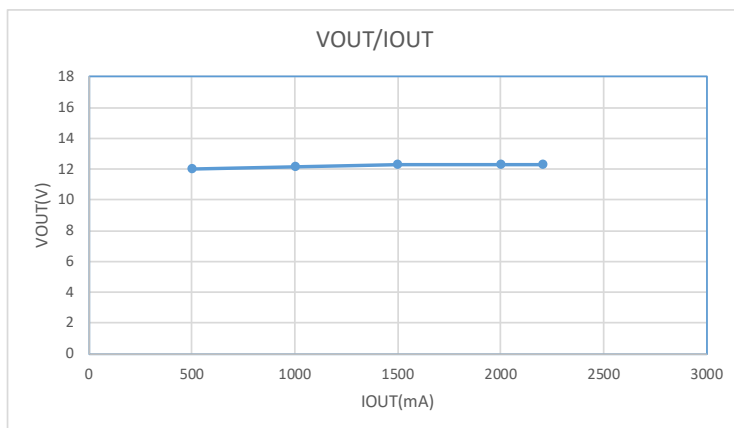

Housing Properties

Degree of protection	IP20
Casing	Polycarbonate, White

Housing Dimensions

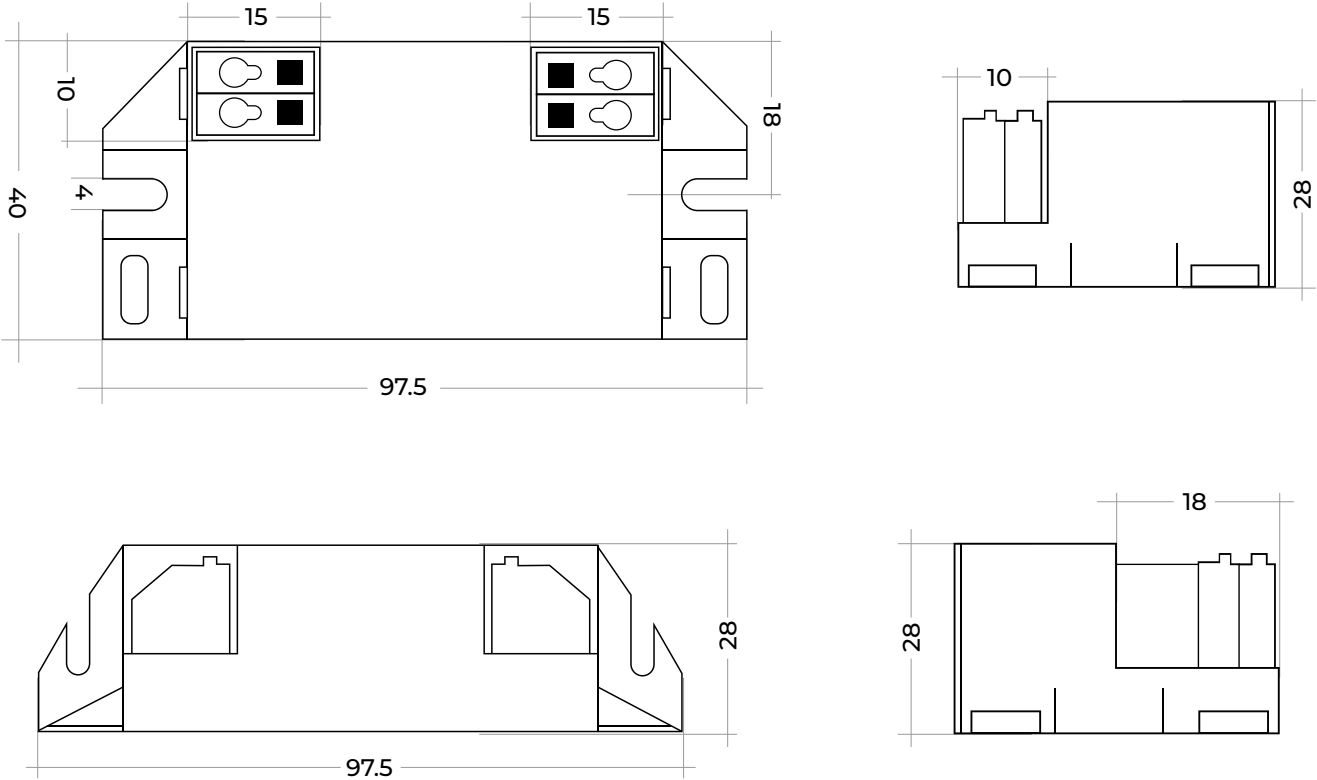

Dimensions	97.5*40*28mm
Tolerance	± 1mm
Weight	65 gm

Wiring Diagrams

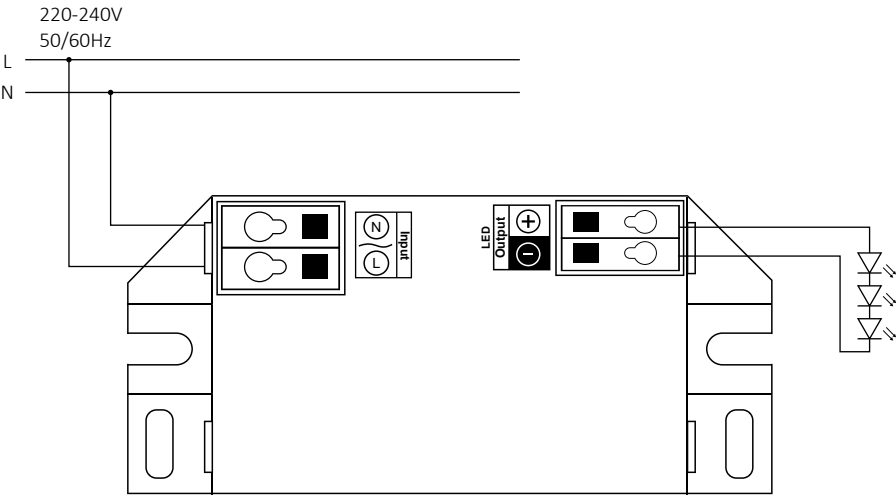

Expected Lifetime

Lifetime	30,000 hours
Warranty	2 years

Logistics Data

Model No.	LS30ISI122500F
Weight (gm)	65 gm