

# COLOSSUS<sup>TM</sup>

*Excellence inside*

**DATASHEET**

**LS10IHIBLECCT40250F**

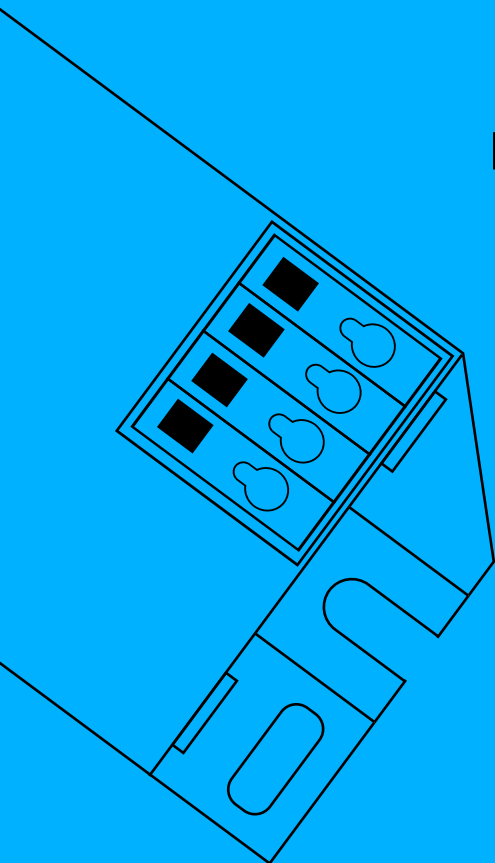

POWERED BY  **plexilent**  
simplifying life

**tuya**<sup>®</sup>

Version: 01

[www.colossusworld.com](http://www.colossusworld.com)

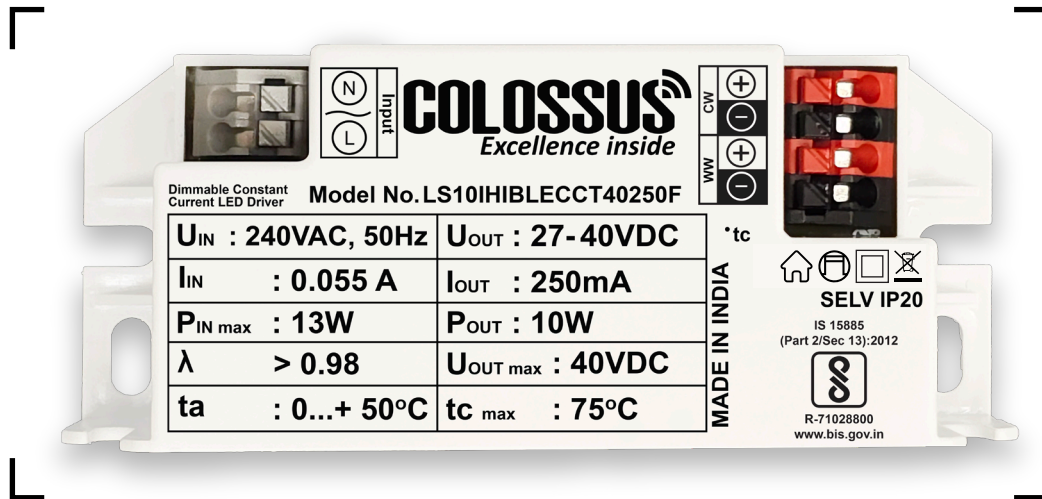

<https://colossusworld.com/>

\*Image is for viewing purpose. Technical Data not to be drawn from above image.

### Approval Markings:



### Product Description

- Smart Dimmable Constant Current Driver For Led Modules
- Input Voltage 240VAC
- High Efficiency >88%(@100% Load)
- Power Factor >0.98, THD<10%(@100%Load)
- For use in combination with Luminaries of Protection Class II
- Protection against Abnormal Operating Conditions Like Open Voltage Protection.
- Surge Protection 4KV
- Compatible with BLE, BLE MESH & ZIGBEE Module
- Nominal Life Time: 30,000 hours @  $t_c \leq t_{cmax}$

### Functions

- Seamless Control
- CCT & Dimming Control
- Application oriented operation for maximum compatibility

### Benefits

- 1-100% Deep Dimming
- Low Standby Power
- Smooth Transition over wide range of CCT & Intensity

### Applications



## Technical Data

### Mains Voltage Supply

Rated Voltage Range	240VAC
Rated Frequency	50/60 Hz
Max. Admissible Input Voltage Range(AC)	175-265VAC
Total Harmonic Distortion (THD)	<10% (@Full Load)
Mains Voltage Withstanding Capacity	350VAC for 2hrs

### Output Data

#### Constant current

Output Current Tolerance	±5%
Max. Ripple Output Current(With Led Load)	<30%
Max Starting Time	<1s

### Interface And Dimming Operation

Dimming Interface	PWM
-------------------	-----

### Power Factor

240V(@ Full Load)	>0.98
-------------------	-------

### Efficiency(typ.)

Full Load	>88%
-----------	------

### Protections

Open Circuit	<55VDC
Output Short Circuit Operation	N.A
Input Over Voltage Cutoff	N.A
Input Under Voltage Cutoff	N.A

### Connection Terminals

	For solid Or stranded wire
Type	Push Terminal
Wire Cross Section	0.5mm <sup>2</sup> - 1.5mm <sup>2</sup>
Wire Stripping Length	8.5mm - 9.5mm

### Wire Lengths

Max. Wire Length To Led Module	<1m
--------------------------------	-----

### Protection

Surge	4kV
High Voltage	350V

### Temperatures (Operation)

Model No.	Ambient(ta)	Case (tc)
LS10IHIBLECCT40250F	0°C... +50°C	Max + 75°C

### Product Specifications

Model No.	Input Current (max)	Input Power (max)	THD	Power Factor	Efficiency	Output Current	Output Voltage	Output Power (max)
LS10IHIBLECCT40250F	55mA	13W	<10%	>0.98	>88%	250mA	27-40V	10W

All specifications with 240 VAC are nominal operation and 100% load.

### Graphs

Operating Window

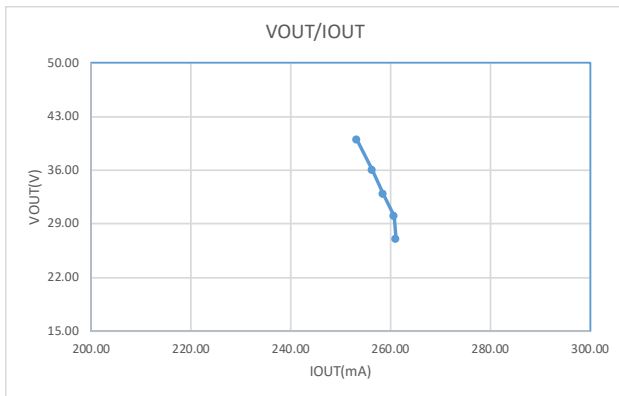

Efficiency Vs Output Power

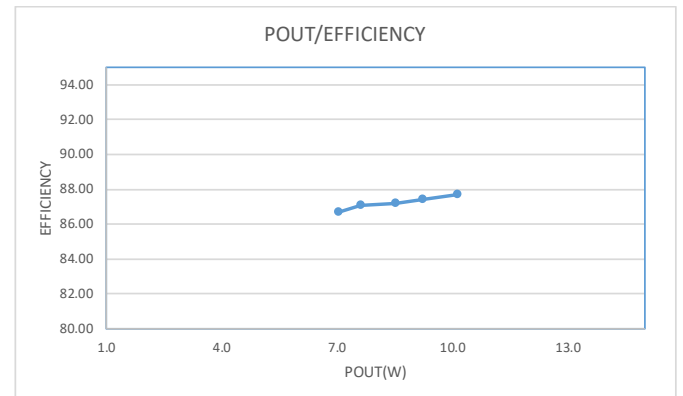

THD Vs Output Power

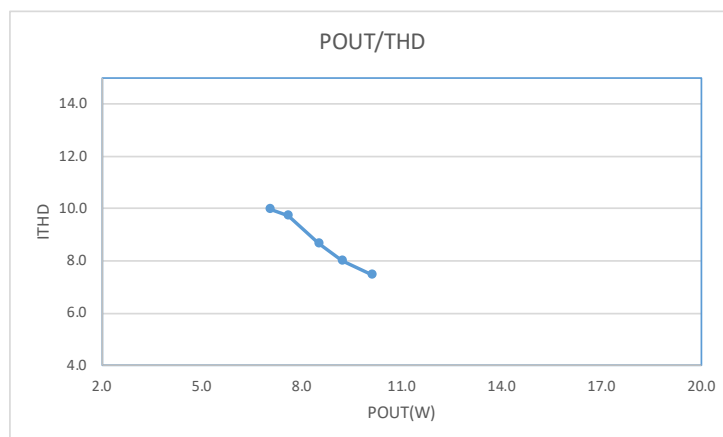

## Housing Properties

Degree of protection	IP20
Casing	Polycarbonate, White

## Housing Dimensions

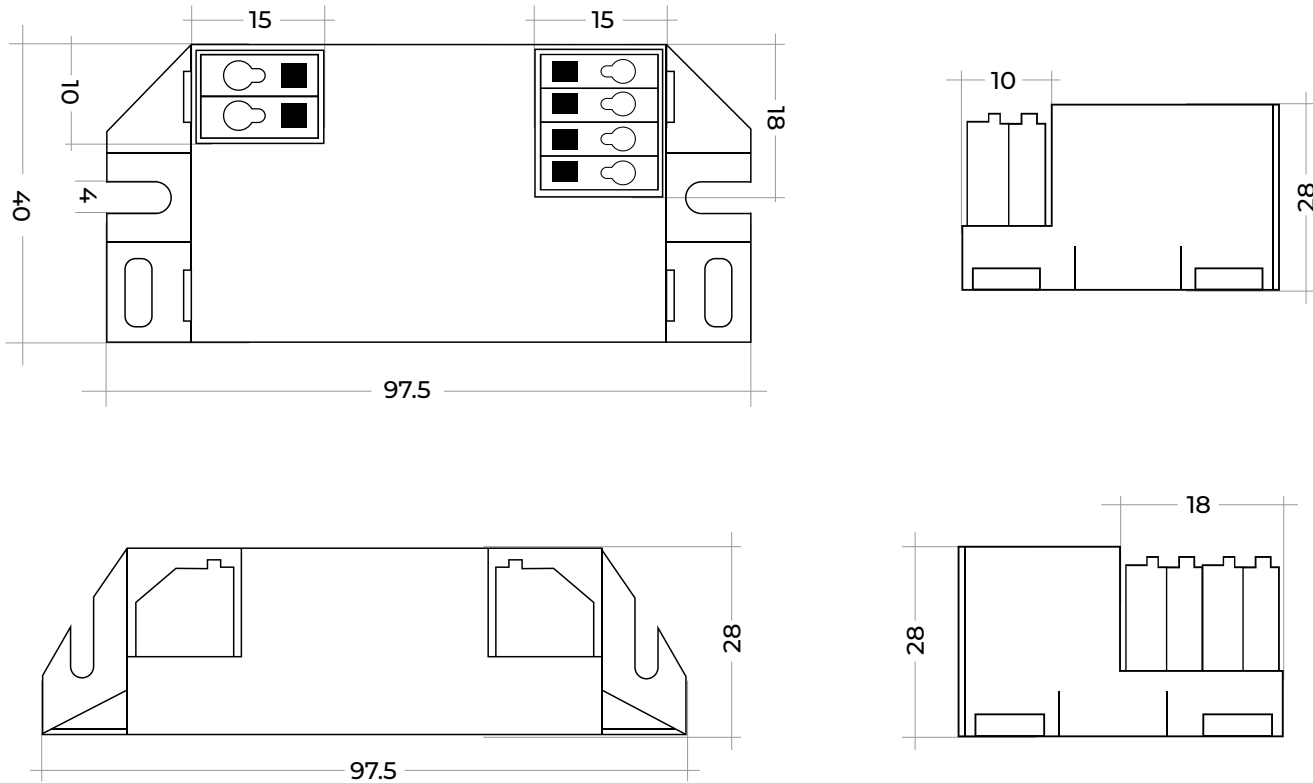

<b>Dimensions</b>	97.5*40*28mm
<b>Tolerance</b>	± 1mm
<b>Weight</b>	55 gm

**Wiring Diagrams**

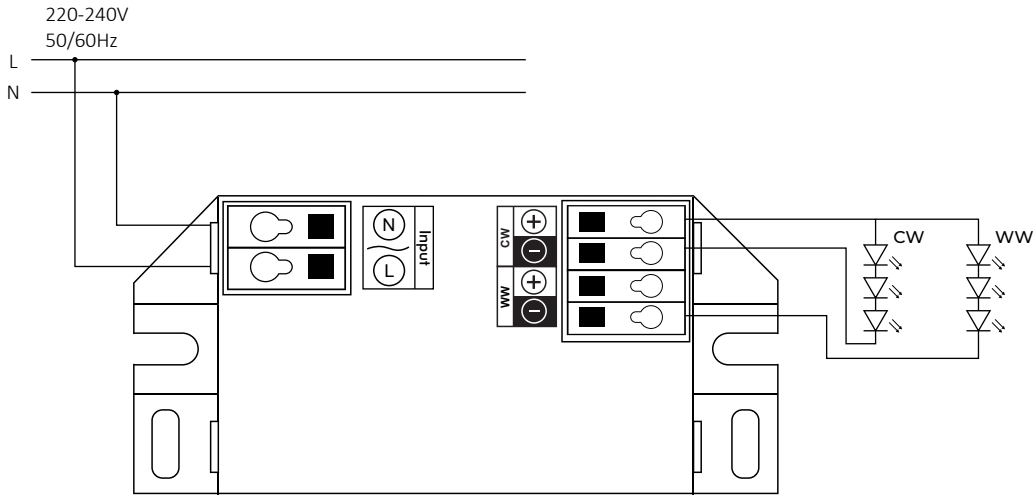

**Expected Lifetime**

Lifetime	30,000 hours
Warranty	2 years

**Logistics Data**

Model No.	LS10IHIBLECCT40250F
Weight (gm)	55 gm