

COLOSSUSTM

Excellence inside

DATASHEET

LS24NSIBEACCT80300F

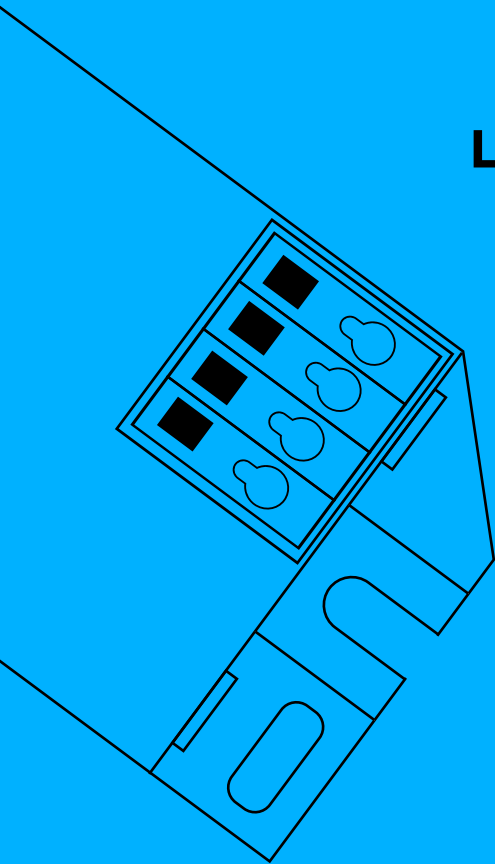

POWERED BY  **plexilent**
simplifying life

Version: 01

www.colossusworld.com

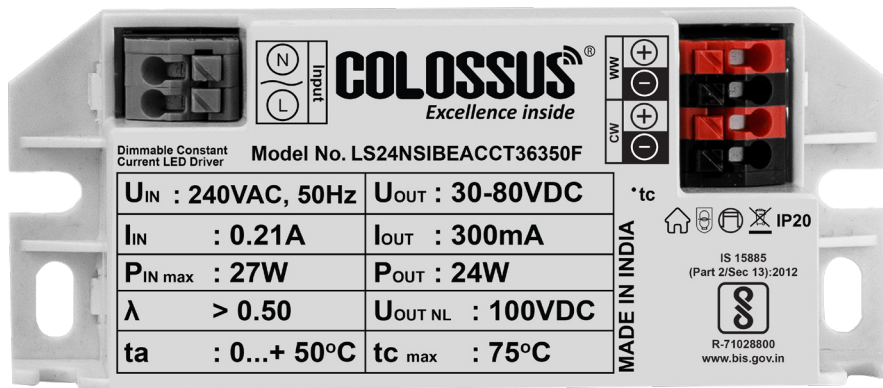

<https://colossusworld.com/>

*Image is for viewing purpose. Technical Data not to be drawn from above image.

Approval Markings:



Product Description

- Smart Dimmable Constant Current Driver For Led Modules
- Input Voltage 240VAC
- High Efficiency >90%(@100% Load)
- Power Factor >0.50 (@100%Load)
- Protection against Abnormal Operating Conditions Like Open Voltage Protection, Short Circuit Protection
- Surge Protection 2.5KV
- Compatible with BLE Beacon.
- Nominal Life Time: 20,000 hours @ $t_c \leq t_{cmax}$

Functions

- Seamless Control
- CCT & Dimming Control
- Application oriented operation for maximum compatibility

Benefits

- Low Standby Power
- Smooth Transition over wide range of CCT & Intensity

Applications



Technical Data

Mains Voltage Supply

Rated Voltage Range	240VAC
Rated Frequency	50/60 Hz
Max. Admissible Input Voltage Range(AC)	175-265VAC
Total Harmonic Distortion (THD)	NA
Mains Voltage Withstanding Capacity	300VAC for 2hrs

Output Data

Constant current

Output Current Tolerance	±5%
Max. Ripple Output Current(With Led Load)	<5%
Max Starting Time	<1s

Interface And Dimming Operation

Dimming Interface	PWM
-------------------	-----

Power Factor

240V(@ Full Load)	>0.50
-------------------	-------

Efficiency(typ.)

Full Load	>90%
-----------	------

Protections

Open Circuit	<100VDC
Output Short Circuit Operation	YES
Input Over Voltage Cutoff	N.A
Input Under Voltage Cutoff	N.A

Connection Terminals

	For solid Or stranded wire
Type	Push Terminal
Wire Cross Section	0.5mm ² - 1.5mm ²
Wire Stripping Length	8.5mm - 9.5mm

Wire Lengths

Max. Wire Length To Led Module	<1m
--------------------------------	-----

Protection

Surge	2.5kV
High Voltage	300V

Temperatures (Operation)

Model No.	Ambient(ta)	Case (tc)
LS24NSIBEACCT80300F	0°C... +50°C	Max + 75°C

Product Specifications

Model No.	Input Current (max)	Input Power (max)	THD	Power Factor	Efficiency	Output Current	Output Voltage	Output Power
LS24NSIBEACCT80300F	210mA	27W	NA	>0.50	>90%	300mA	30-80V	9-24W

All specifications with 240 VAC are nominal operation and 100% load.

Graphs

Operating Window

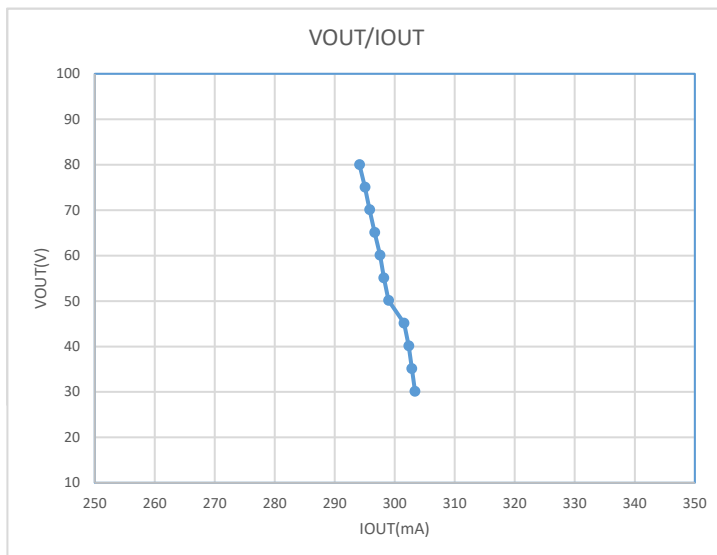

Efficiency Vs Output Power

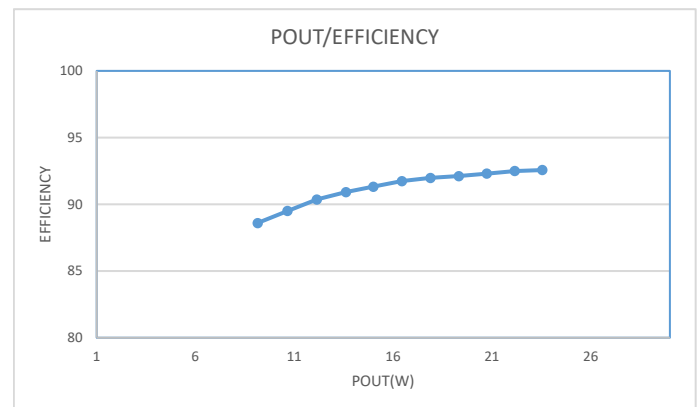

Housing Properties

Degree of protection	IP20
Casing	Polycarbonate, White

Housing Dimensions

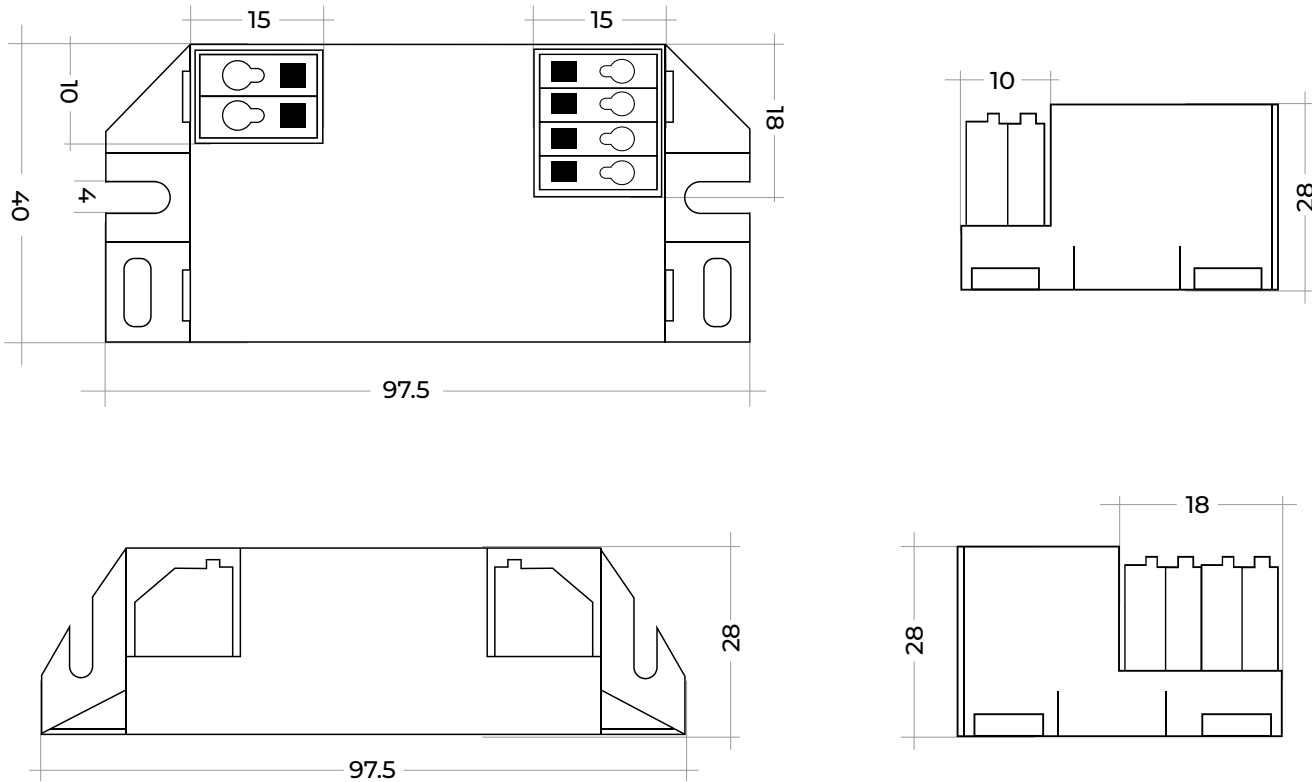

Dimensions	97.5*40*28mm
Tolerance	± 1mm
Weight	55 gm

Wiring Diagrams

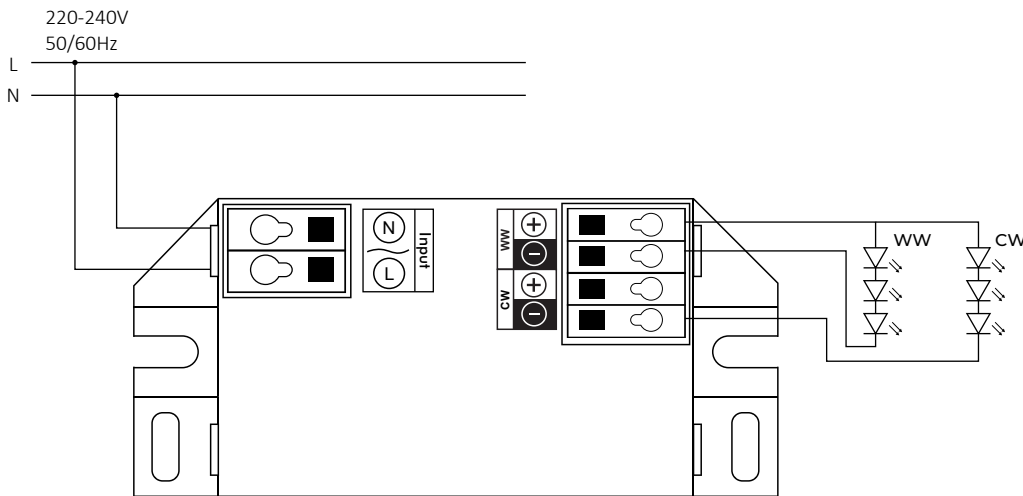

Note: For 3-Wire Connection, Use Any 1 Output Positive Terminal And Keep Other Positive Terminal N.C (Not Connected).

Expected Lifetime

Lifetime	20,000 hours
Warranty	1 Year

Logistics Data

Model No.	LS24NSIBEACCT80300F
Weight (gm)	55 gm